

TierraCast®

Quality in the Making

TierraCast's line of leather findings are stylish, trendy and refreshingly easy to use! This tip sheet will cover the many components available as well as illustrated step-by-step instructions for setting rivets and eyelets.

RIVETS, EYELETS & WASHERS

These simple yet decorative parts are engineered to work with TierraCast's leather strap and their cast components. It only takes a few whacks with TierraCast tools to set components beautifully and consistently.

COMPRESSION RIVETS

Also known as leather rivets. Available in 6 finishes.



MICRO WASHERS

Essential when riveting with leather, washers help keep rivets from tearing through the leather. Available in six finishes.



EYELETS

Available in three lengths and 6 finishes.



RIVETABLE ACCENTS

Sized to attach with TierraCast's 4mm rivets, and 5.3mm and 6.8mm eyelets.



FOCAL LINKS

Also known as connectors, these focals work beautifully with TierraCast 4mm rivets, eyelets or in the case of the Frame Slide, just slide it on. You can also use these with 2mm leather or chain! Can be flattened and re bent with bending pliers.



STRAP TIPS

With holes made to accommodate 4mm rivets and eyelets, TierraCast Strap Tips are sophisticated options for finishing leather designs.



CLOSURES

TierraCast's new clasp components complement the design themes found in their leather finding product lines. Z & E hooks and end bars are perfectly sized to use with TierraCast leather strap.

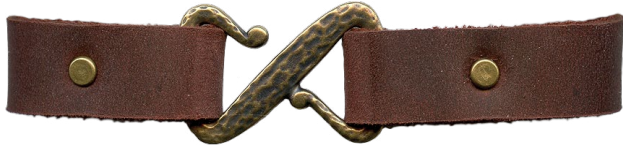

HOOKS



#39-195-05-6
Large Classic Hook
Available in 3 finishes



#39-195-10-AC
Twisted Hook
Available in 5 finishes

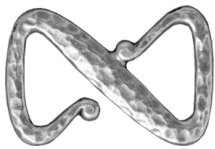

#39-195-06-5
Textured "Z" Hook
Available in 3 finishes



#39-195-09-AB
Floral "Z" Hook
Available in 3 finishes



#39-195-07-9
Small Plain "E" Hook
Available in 6 finishes



#39-195-08-4
Large Plain "E" Hook
Available in 6 finishes

TRIBUCKLES

To use, rivet or knot your cord on the smallest opening, then thread the other end of the cord through the wider openings. There is a ridge on one side of the buckle and should be on the tip side.



#39-195-20-7
18mm Tribuckle
Available in 3 finishes

Reverse



#39-195-21-5
28mm Tribuckle
Available in 3 finishes

END BARS



#69-982-05-7
Distressed End Bar
Available in 3 finishes



#69-982-09-AB
Floral End Bar
Available in 3 finishes



#69-982-10-AS
Bamboo End Bar
Available in 3 finishes

BARREL BEADS & SLIDES

Slide or crimp these on cord, 2mm leather and leather strap.



#49-957-70-AB
4x2mm Deco Barrel
Available in 3 finishes



#49-957-71-AC
6x2mm Deco Barrel
Available in 3 finishes



#49-957-72-AS
12x2mm Deco Slide
Available in 3 finishes

SNAP CAPS

Designed to compliment other TierraCast leather findings, these caps are great for enhancing snaps.



#69-982-21-7
Spiral
Available in 3 finishes



#69-982-20-6
Rock & Roll
Available in 3 finishes

TOOLS

Precision design and manufacturing for professional results. Made of long lasting stainless steel, these setting tools are precision designed to work with TierraCast rivets and eyelets. The hex shaped setters are comfortable to hold and won't roll off your table! *Shown reduced.*



#69-348-04
4mm Rivet Setter



#69-348-06
6mm Rivet Setter



#69-363
Eyelet Setter
& Anvil

OTHER ESSENTIAL TOOLS



#69-105
Leather hole punch



#69-108
Steel Block



#69-345
Hammer

HOW TO SET RIVETS

1. Gather supplies. Choose your components and determine the hole placement on the leather. Mark the location with a pen or Sharpie®.



2. Punch a 2mm hole in the leather using a leather hole punch. Number 2 on the rotary punch is 2mm.



3. Push the peg of the post (the long portion of the rivet) through the back side of the leather.



4. Layer the items to be riveted on top of the steel block as shown.

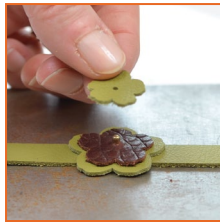

5. Slide the cap (domed portion) over the post.



6. Position the cupped end of the rivet setter vertically over the cap.
7. Tap once or twice with a hammer. Brass head hammers are recommended.
8. Test for firmness. If the rivet can move or wiggle, reposition on the block and tap a little harder until firm.

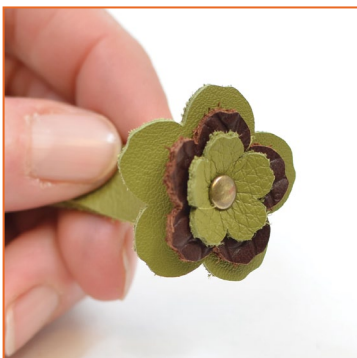
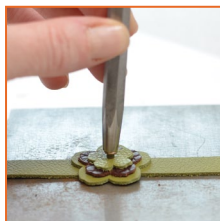

HOW TO SET EYELETS

1. Choose your components and measure their thickness to decide which eyelet to use. **This is critical to a successful setting.** If the eyelet is too long, it will bend and end up crooked, if it's too short you won't have a secure hold.



3.7mm eyelet
*To decorate leather only,
for 2.5-3mm of material*



5.3mm eyelet
*Holds 2 pieces together,
3-4.5mm of material*



6.8mm eyelet
*Long enough to stack
4-5-6mm of materials*

2. Gather the rest of your supplies and tools.



3. Determine the hole placement on the leather and mark the location with a pen or Sharpie®. If your using black leather, you can use an awl to mark your placement by poking a small hole.



4. Punch 2mm holes in the leather using a leather hole punch. Number 2 on the rotary punch.



5. Beginning with the eyelet, layer the items to be riveted over the divot on the anvil. Eyelet + leather + washer.



6. Position the setter vertically over the unfinished end of the eyelet.

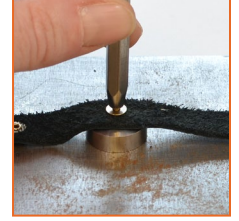

7. Tap tap a few with a hammer. Brass head hammers are recommended.



8. Test for firmness. If the setting can move or wiggle, reposition on the block and tap a little harder until firm.



HOW TO ADD HOOK CLOSURES

To add a hook closure, follow the same basic riveting or eyelet setting instructions.

1. Slide the end of the strip through the closed end of the hook.

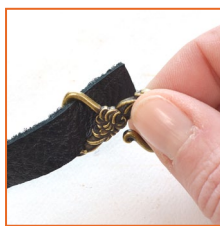

2. Fold the strip over. Leave enough room to rivet (about 3/4" overlap).



3. Punch holes through both pieces of leather.



4. Insert rivet/eyelet through the hole of the (rivetable if your using one, and) leather.

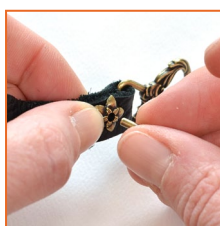

When using a rivetable - be sure to leave extra space between the rivetable and the clasp.

5. Turn over and add: the washer if using an eyelet, or the end cap if using a rivet.

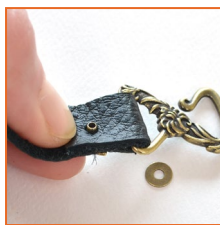

6. Set the rivet or eyelet.

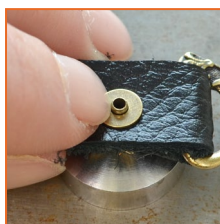

7. Repeat steps 2-6 for the other side.

MORE TECHNIQUES & INFO

Rings & Things offers instruction and tips on a variety of jewelry making mediums and techniques!

- #68-007-01 *Jewelry Basics*
- #68-007-02 *Pendant Cord Tying*
- #68-007-03 *Gluing to Metal*
- #68-007-04 *ITS™ (Image Transfer)*
- #68-007-06 *Earring Basics*
- #68-007-07 *Metal Stamping*
- #68-007-08 *Epoxy Resin*
- #68-007-09 *Stamping on Resin*
- #68-007-10 *Disk/Loop Bracelet*
- #68-007-11 *No-Solder Bezels and Frames*
- #68-007-12 *Cold Connections*
- #68-007-13 *Oxidizing Metal*
- #68-007-14 *Crafted Findings Riveting System*
- #68-007-15 *Snap/Rivet Setting*
- #68-007-16 *Metal Etching*
- #68-007-17 *Glass Pendant Soldering*

